

The real STP Cat. 6 solution, easy to install...

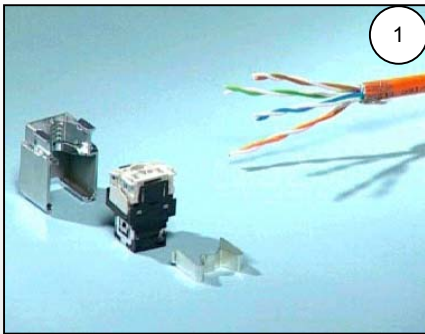

1 Prepare the cable, fold shield back over insulation

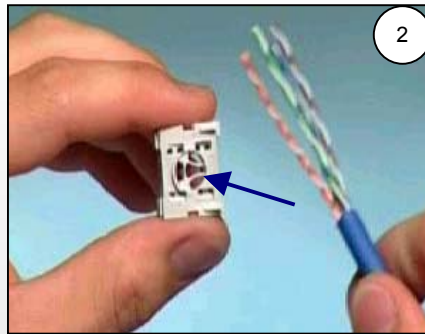

2 Insert the blue pair into the highlighted opening

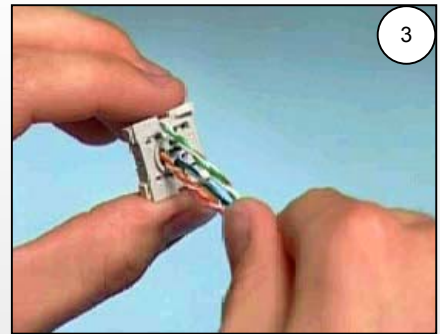

3 Feed the other pairs in clockwise and slide cable manager back to the cable sheath

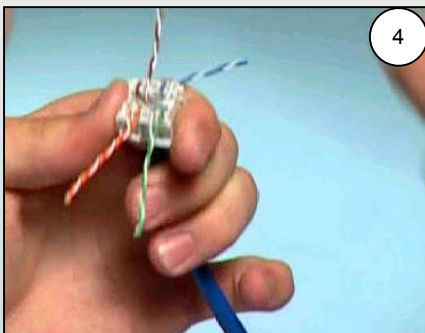

4 Insert individual wires into the coloured-coded wiring slots

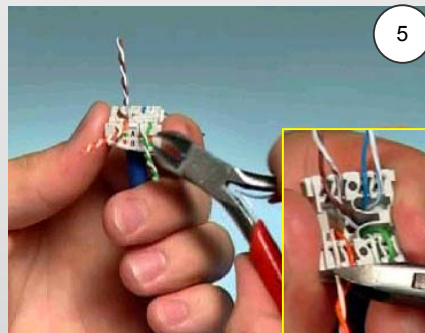

5 Cut off the individual wire (as close to the cable manager as possible) by using side cutters

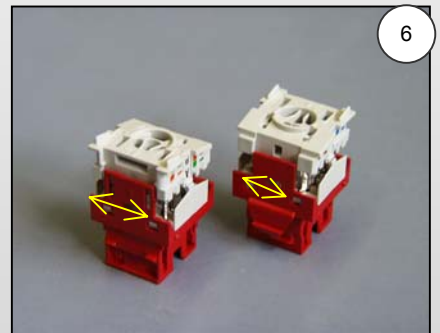

6 Place RJ45 jack onto the cable manager. (small latch into small groove, larger latch into larger groove)

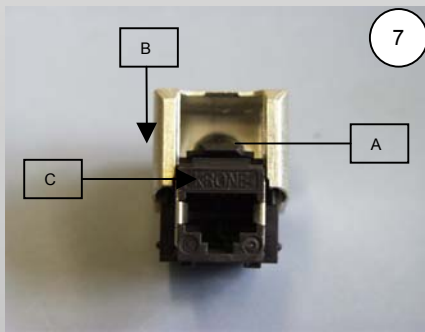

7 Fit the die-cast cover:
(A) Oval opening on the cable
(B) Install from the top
(C) KRONE Logo visible

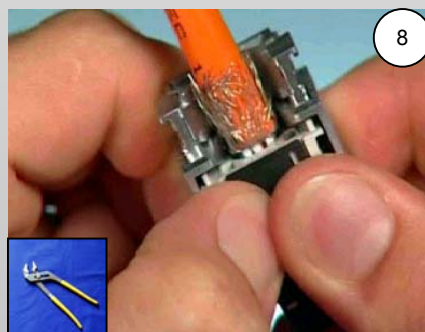

8 Compress RJ45 jack and cover



9 Press shield clip into cover guide



Colour-coding of RJ45 sockets



KRONE

■ According to Structured Cabling standards EIA/TIA 568, ISO/IEC 11801 or EN 50173 both ends of the cabling must be terminated on the same pins. To this end, the pairs, pins and their colours standardised. There are two permitted versions: EIA/TIA 568A and EIA/TIA 568B, these are only different in the pair termination layout. (green and orange [Pairs 2 and 3] being reversed).

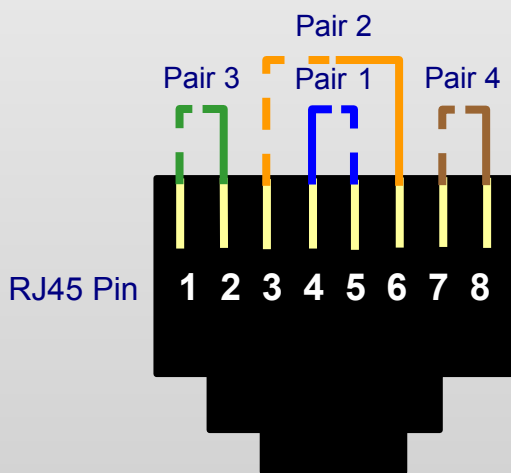

RJ45 Pin-out
T568A

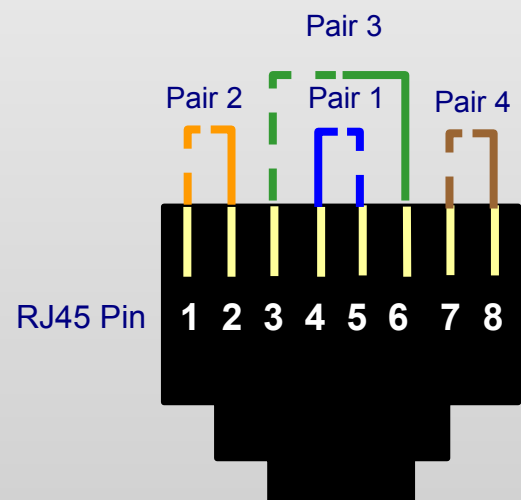

RJ45 Pin-out
T568B

